

**Patching • Seal Coating • Striping
Complete Tennis Court • Concrete
Construction and Resurfacing •
Hot Pour Crack Filling
Lic. #A-748-240**

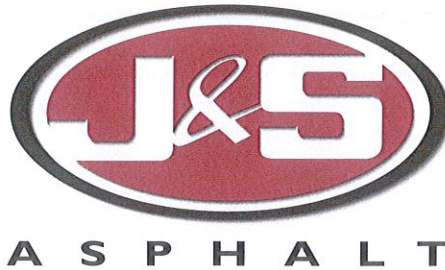

**4512 Yankee Hill Court
Rocklin, CA 95677-1603
(916) 624-8855
FAX 624-8879**

HIDDEN VALLEY HOME OWNERS ASSOCIATION
MORNINGSIDE DRIVE, GLEN LANE, WILLOW LANE, WEST LANE, PINEGATE LANE, AND HIDDEN LANE
GRANITE BAY, CA

RE: STREET SEAL COATING & STRIPING

ATTN: ALL RESIDENTS

PLEASE BE ADVISED!!!!

J&S ASPHALT WILL BE DOING STREET SEAL COATING AND STRIPING FOR ALL OF HIDDEN VALLEY HOME OWNERS ASSOCIATION ROADS JULY 29TH (MONDAY) THROUGH AUGUST 2ND (FRIDAY).

ALL STREETS TO BE SEALED WILL BE BARRICADED AND CLOSED FROM 7:00AM UNTIL 5:00PM FOR EACH SECTION EACH DAY AS SHOWN ON THE PROVIDED SITE MAP. WE REQUEST ANYONE HAVING TO LEAVE ON THIS DAY THAT ALL CARS ARE REMOVED FROM THE HOME OWNERS ASSOCIATION BY NO LATER THAN 7:00AM AND NOT RETURN UNTIL AFTER 5:00PM. ANY CARS REMAINING IN PERSONAL DRIVEWAYS AFTER 7:00AM WILL HAVE TO REMAIN PARKED IN PERSONAL DRIVEWAYS, NO STREET PARKING ALLOWED AND WILL NOT BE ALLOWED TO LEAVE, DRIVE VEHICLES ON THE STREETS OR MOVE UNTIL AFTER 5:00PM WHEN STREETS ARE REOPENED.

ALL IRRIGATION, LANDSCAPING WATER, AND CAR WASHING WATER TO REMAIN OFF ON THIS DAY, ALL STREETS NEED TO REMAIN DRY TO COMPLETE THE WORK.

OUR GOAL IS TO COMPLETE THIS PROJECT IN AN EFFICIENT MANNER, NO BARRICADES ARE TO BE REMOVED OR OPENED BY ANY HOMEOWNERS PLEASE.

J&S ASPHALT WILL BE STAFFED APPROPRIATELY WITH UNIFORMED MEMBERS, WHO WILL ASSIST YOU AND YOU'RE TENANTS AS NEEDED.

PLEASE NOTIFY AND MAKE THE NECESSARY ARRANGEMENTS FOR NO ACCESS BY UPS, FED EX OR POST OFFICE DELIVERIES, LANDSCAPERS OR ANY OTHER OUTSIDE VENDORS DUE TO ROAD SEAL COATING AND CLOSURE.

(THIS IS A FORMAL NOTIFICATION), THE WET SEAL COAT (BLACK OIL TAR) AND STRIPING PAINT WILL TRACK ON CARPET, CONCRETE, AND IN OR ON CARS IF WALKED ON OR DRIVEN THROUGH UNTIL PROPERLY CURED. J&S ASPHALT WILL NOT BE LIABLE FOR ANY DAMAGE OCCURRED FROM WET SEAL COAT OR PAINT.

THANKS FOR YOUR COOPERATION.
SINCERELY,
J&S ASPHALT

CONTACT PERSON - TERRY BURLEY (916) 417-6465

JULY 29TH MORNING SIDE LANE
MONDAY

JULY 30TH MORNING SIDE LANE
TUESDAY

JULY 31ST MORNING SIDE LANE
AND ONE GREEN LANE
WEDNESDAY

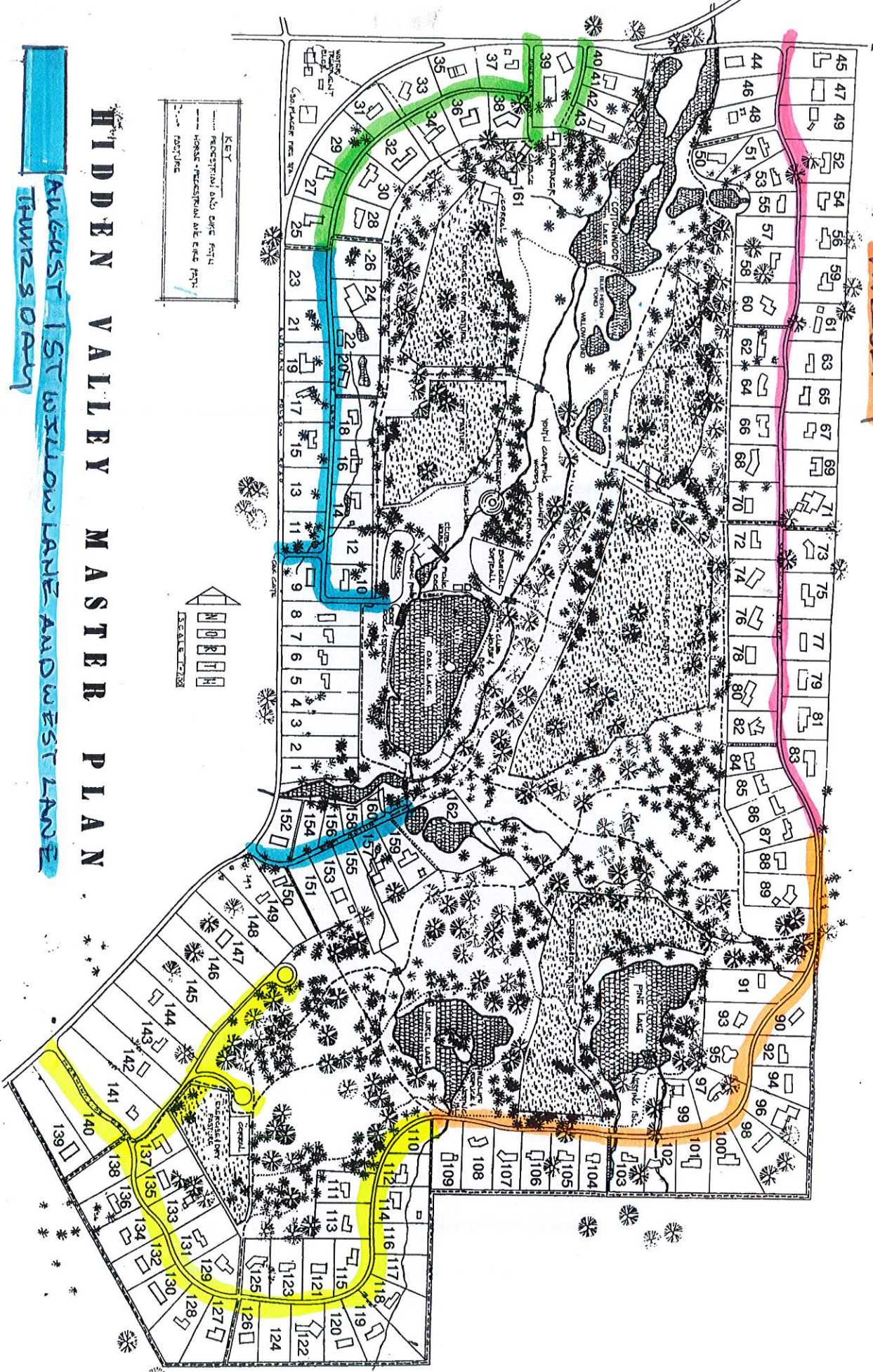

KEY
..... RECREATIONAL AREA
- - - - - DIRT PATH
- - - - - HOUSING - RECREATIONAL AREA PATH
- - - - - STRUCTURE

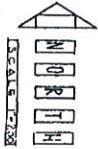

HIDDEN VALLEY MASTER PLAN

AUGUST 1ST WILLOW LANE AND WEST LANE
THURSDAY

AUGUST 2ND WEST LANE, PINEGATE LANE AND HIDDEN LANE
FRIDAY